



HiCon International

Architects Interior Designers
Engineers & Developers



A Subsidiary of:
SAMPAK



About US

HiCon International was established in 1988. It is a sister concern of **Sampak**, established to introduce quality construction under Sampak's supervision.

The main purpose of the Company is to execute construction projects with excellence and state of the art techniques. This is ensured by a dedicated technical team, quality control and efficient project management and execution.



HICON International

Head Office:

G-569, Johar Town, Lahore- Pakistan

Telephone: 92-42-35300745-46

E-mail: sampak.int@gmail.com

Central Testing Laboratory

Beer Pind, Near Mian Plaza

Block B, Johar Town, Lahore

Cell # 0301-4994398/0309-4337633



<https://hiconinternational.com.pk/>



<https://www.facebook.com/HiConInternational.com.pk>



<https://www.instagram.com/hiconinternational.com.pk/>



<https://twitter.com/HiConInt>



<https://www.linkedin.com/in/hiconinternational/>



<https://www.youtube.com/channel/UC40BB8GfxYqiGcmjUOhIPYg>

Experience

- Team of Highly Qualified Professional Engineers
- Experienced Team Members for Working Abroad & With International Clients
- Renowned Architects & Interior Designers
- Experts in Planning & Scheduling, Project Monitoring
- Well Equipped Quality Control Lab. & Testing Services
- Complete Engineering & Construction Supervision Services
- Turnkey Construction & Renovation Solutions of Residential, Commercial buildings & infrastructural Works of societies

**Complete
Building
Solutions!**





KEY PERSONNEL



KEY TEAM MEMBERS



Engr. SMA Shirazi (Late)
Founder

Engr. Hasan A. Shirazi
Managing Director

Syed Adnan Ali

Engr. Naeem J Ali
General Manager

**Sampak International &
Hi Con International**

Established the companies based on high moral and professional standards. Which we aim to carry in all the works we execute

**Sampak International &
HiCon International**

Over 27 years experience in Commercial & Residential Buildings Motorways & Highways, Bridges, Technical Studies, CSR

HiCon International

Interior Designer
20 years experience
Geologist

HiCon International

Over 27 years experience in Commercial & Residential Buildings Motorways & Highways, Planning & Schedule, Pipelines, Construction



MAJOR PROJECTS



MAJOR PROJECTS

PLANNING, DETAILED DESIGNING AND CONSTRUCTION SUPERVISION OF
912 NOS. E-TYPE APARTMENTS AND 672 NOS. B - TYPE APARTMENTS ALONG
WITH INFRASTRUCTURE DEVELOPMENT WORKS AT SECTOR I-16/3
ISLAMABAD

Client:

Pakistan Housing
Authority

Location:

Sector I/16 Islamabad

Project Cost:

Rs. 8,000 Million



View of E Type 912 Apartments I-16/3,
Islamabad



View of B Type 672 Apartments I-16/3,
Islamabad

- ✓ Engineering
- ✓ Architecture
- ✓ Town/Master Planning
- Interior Design
- ✓ Construction Management
- ✓ Geotechnical & Testing
- ✓ Topographic Surveys
- Renovations
- ✓ Feasibility Reports
- ✓ Planning & Scheduling



MAJOR PROJECTS

DESIGN AND CONSTRUCTION SUPERVISION OF CONCRETE WHEAT SILOS 30,000 M. TONS CAPACITY AT BAHAWALPUR DISTRICT

Client:

Food Department, GOP

Location:

Bahawalnagar (Punjab)

Project Cost:

Rs. 700 Million



- ✓ Engineering
- ✓ Architecture
- ✓ Town/Master Planning
- Interior Design
- ✓ Construction Management
- ✓ Geotechnical & Testing
- ✓ Topographic Surveys
- Renovations
- ✓ Feasibility Reports
- ✓ Planning & Scheduling



MAJOR PROJECTS

CONSTRUCTION SUPERVISION OF 2359 NOS. DANGEROUS SCHOOL BUILDINGS PHASE-I& II.

Client:

Education Department
Government of the Punjab

Location:

Punjab Kasur, Attock,
Gujrat, Narowal, Faisalabad,
D.G.Khan, Sialkot, Sargodha
and Gujranwala Phase-II,
Punjab Attock, Sialkot,
Layyah, T.T Singh, Okara,
Sahiwal, Pakpattan,
Khanewal, Multan & D.G
Khan Phase-I

Project Cost:

Rs. 7000.00 Million



- ✓ Engineering
- ✓ Architecture
- ✓ Town/Master Planning
- Interior Design
- ✓ Construction Management
- ✓ Geotechnical & Testing
- Topographic Surveys
- ✓ Renovations
- ✓ Feasibility Reports
- ✓ Planning & Scheduling



MAJOR PROJECTS

PLANNING, DETAILED DESIGNING AND CONSTRUCTION SUPERVISION OF 400 NOS. C-TYPE AND 208 NOS. E-TYPE APARTMENTS AT SECTOR G-11/3 ISLAMABAD

Client:

Pakistan Housing Authority

Location:

Sector G-11/3 Islamabad

Project Cost:

Rs. 1607 Million



View of E Type 400 Full Apartments G-11/3, Islamabad



View of C Type 208 Full Apartments G-11/3, Islamabad

- ✓ Engineering
- ✓ Architecture
- ✓ Town/Master Planning
- Interior Design
- ✓ Construction Management
- ✓ Geotechnical & Testing
- Topographic Surveys
- Renovations
- ✓ Feasibility Reports
- ✓ Planning & Scheduling



MAJOR PROJECTS

PROJECT MANAGEMENT CONSULTANCY FOR THE CONSTRUCTION OF 400 APARTMENTS AND 580 LOW COST APARTMENTS, KUALA LIMPUR & IPOH, MALAYSIA

Client:

Taman Sumandra

Location:

Kuala Lumpur,
Malaysia

Project Cost:

Rs. 600 Million



- ✓ Engineering
- ✓ Architecture
- ✓ Town/Master Planning
- Interior Design
- ✓ Construction Management
- ✓ Geotechnical & Testing
- Topographic Surveys
- Renovations
- ✓ Feasibility Reports
- ✓ Planning & Scheduling



MAJOR PROJECTS

PLANNING, DESIGNING AND CONSTRUCTION SUPERVISION OF 10 NOS SERVICE AREAS ON LAHORE ISLAMABAD MOTORWAY M-2

Client:

National Highway
Authority
DAEWOO Corp. Korea

Location:

10 No. Service Areas
on M-2

Project Cost:

Rs. 2500 Million



- ✓ Engineering
- ✓ Architecture
- ✓ Town/Master Planning
- Interior Design
- ✓ Construction Management
- ✓ Geotechnical & Testing
- Topographic Surveys
- Renovations
- ✓ Feasibility Reports
- ✓ Planning & Scheduling



MAJOR PROJECTS

DESIGN AND CONSTRUCTION SUPERVISION OF MCDONALD RESTAURANTS (SIX NOS) IN LAHORE AND FAISALABAD

Client:
McDonald's Pakistan
Location:
Lahore Faisalabad
Project Cost:
Rs. 700 Million



- ✓ Engineering
- ✓ Architecture
- ✓ Town/Master Planning
- Interior Design
- ✓ Construction Management
- ✓ Geotechnical & Testing
- Topographic Surveys
- Renovations
- ✓ Feasibility Reports
- ✓ Planning & Scheduling

ARCHITECTURE & INTERIOR DESIGN ASSOCIATES



- ✓ Engineering
- ✓ Architecture
- ✓ Town/Master Planning
- Interior Design
- ✓ Construction Management
- ✓ Geotechnical & Testing
- Topographic Surveys
- Renovations
- ✓ Feasibility Reports
- ✓ Planning & Scheduling

ARCHITECTURE & INTERIOR DESIGN ASSOCIATES



- ☑ Engineering
- ☑ Architecture
- ☑ Town/Master Planning
- ☑ Interior Design
- ☑ Construction Management
- ☑ Geotechnical & Testing
- ☑ Topographic Surveys
- ☑ Renovations
- ☑ Feasibility Reports
- ☑ Planning & Scheduling

ARCHITECTURE & INTERIOR DESIGN ASSOCIATES



- ✓ Engineering
- ✓ Architecture
- ✓ Town/Master Planning
- Interior Design
- ✓ Construction Management
- ✓ Geotechnical & Testing
- Topographic Surveys
- Renovations
- ✓ Feasibility Reports
- ✓ Planning & Scheduling

RENOVATIONS & REFURBISHMENT CAPABILITIES



- ✓ Engineering
- ✓ Architecture
- ✓ Town/Master Planning
- Interior Design
- ✓ Construction Management
- ✓ Geotechnical & Testing
- Topographic Surveys
- Renovations
- ✓ Feasibility Reports
- ✓ Planning & Scheduling

RENOVATIONS & REFURBISHMENT CAPABILITIES



REGIONAL HEAD OFFICE BOP GUJRANWALA



- ✓ Engineering
- ✓ Architecture
- ✓ Town/Master Planning
- Interior Design
- ✓ Construction Management
- ✓ Geotechnical & Testing
- Topographic Surveys
- Renovations
- ✓ Feasibility Reports
- ✓ Planning & Scheduling

RENOVATIONS & REFURBISHMENT CAPABILITIES



MAIN GATE SUI GAS SOCIETY PHASE -2

CENTRAL PARK PEDESTRIAN
BRIDGE

- ✓ Engineering
- ✓ Architecture
- ✓ Town/Master Planning
- Interior Design
- ✓ Construction Management
- ✓ Geotechnical & Testing
- Topographic Surveys
- Renovations
- ✓ Feasibility Reports
- ✓ Planning & Scheduling



SERVICES

Engineering Solutions

HiCon & Sampak International have in-house structural design engineers team equipped with latest software. We has made specifications and prepared Standard Drawings for NHA which have adopted all across Pakistan. The Standard drawings comprise of various RCC structures of bridges designs, multi cell Culverts, RCC Drains, Retaining Walls etc.

HiCon & Sampak International have also a dedicated sections devoted to Public Health Engineering, and have the capability to Design Sewerage, Water Supply and Firefighting systems when doing Town planning or providing solutions for Residential Buildings.

We also have a dedicated section of Electrical Engineers that provide best customized Electrical Solutions for any commercial or residential building.

HiCon & Sampak International have associate engineers that provide HVAC, Solar PV System and all MEP solutions

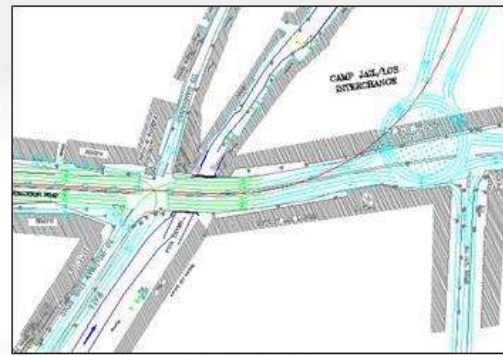
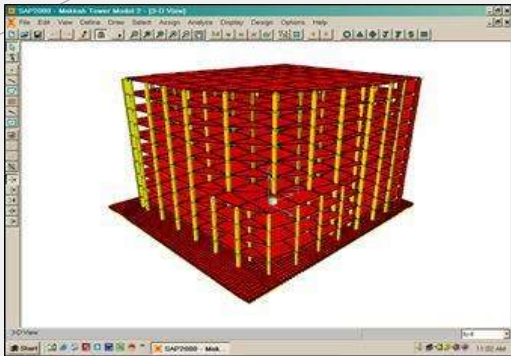
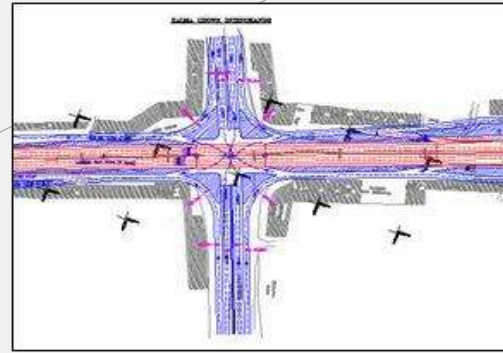
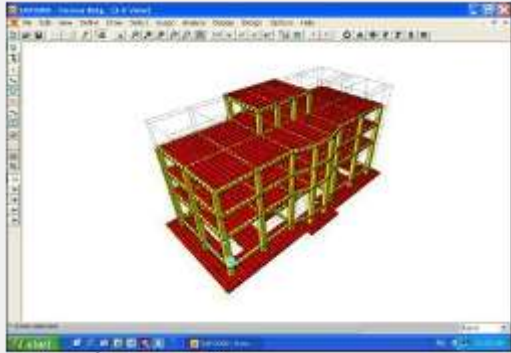

Architectural & Interior Design Solutions

HiCon has its in-house architectural & interior design capabilities.

Hi Con has as its associates several renowned architects and interior designers who are assigned jobs, catering to the need and budget requirement of the client.

HiCon provides architects who are well versed in Modern, Victorian or Spanish type architecture. The company's interior design team proposes customized Kitchen Designs, exclusive Bedrooms and Living room interiors as per clients' requirements.

Our associates are well versed in all visual tools and 3D software so that the client can visualize best architectural and interior solutions.



Construction Management



HiCon has its in-house construction team catered to handle small to large housing projects, as well as infrastructure works of housing societies. It has developed small scale housing projects as well. The company has expertise in construction of small scale plazas and multistory buildings.

HiCon has and many associated construction firms of CA category which it aligns to handle multi billion scale projects. In such projects the company carries out construction management and detailed planning and scheduling as well as monitoring construction to any level.

The company is well equipped to handle projects related to Buildings, Housing Schemes, Highways, Bridges and Hydraulic Structures.

TOWN PLANNING

HiCon has a rich repute in carrying out Town Planning projects all across Pakistan and abroad.

We have developed Master Planes for various schemes, which include Service Area, Housing Colonies, Industrial Areas & Commercial Enterprises.

We have well experienced team of engineers who are well versed in designing road network of any type of housing society. The company is fully capable in handling Roads, Public Health infrastructure & Electrical works.



Sundar Industrial Estate

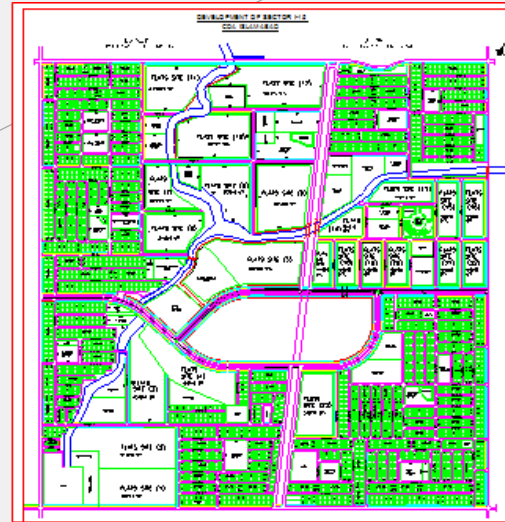

I-15 CDA, Islamabad

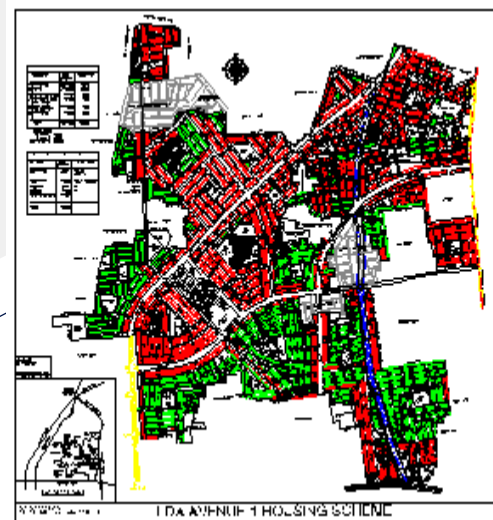

LDA AVE. Phase I

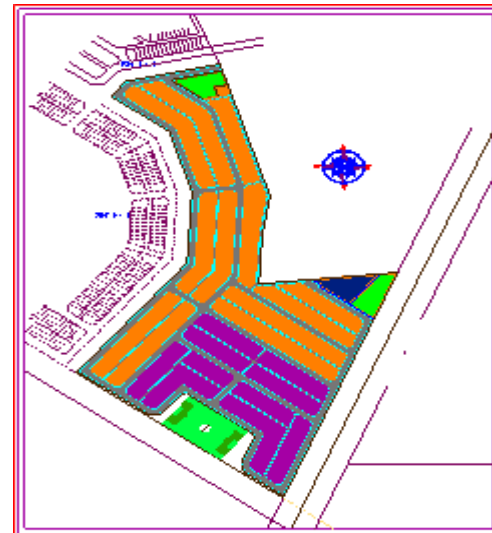

Ipoh City - Malaysia



Compaction Test



Drilling Rig



Geotech Soil
Investigation



Lab. Testing

Geotechnical & Material Testing LAB.

- HiCon is very conscious about quality of construction due to which it maintains its central testing lab. facilities.
- HiCon is equipped with all necessary equipment due to which it can conduct the following tests.
 - Ultrasonic non destructive concrete test.
 - Drilling Rig for Soil Investigation to up to 100m
 - SPT Apparatus
 - Bankleman Beam Apparatus
 - Re-bar Locator
 - Concrete Tests
 - Asphalt Tests
 - Bricks and Blocks Tests
 - Soil, Sand and Aggregate Tests



GGs School before & after



Galaxy Hotel proposed & built



Sui Gas Phase II - Gate

Renovation & Refurbishment

- HiCon specializes in restoring old building structures. It has carried out restoration works on local residences and commercial buildings like restaurants, banks, schools, hotels etc..
- HiCon has experience in restoring old buildings built in limestone.
- HiCon has launched a comprehensive program regarding restoring old houses showing dangerous cracks, or plagued with seepage or water proofing issues.
- HiCon can also renovate old buildings and give it a modern look by replacing new exterior and interior materials.



Head Office:

G-569, Johar Town, Lahore- Pakistan

Telephone: 92-42-35300745-46

Mobile:0313-5482624



E-mail: info@hiconinternational.com.pk

<https://hiconinternational.com.pk/>



<https://www.facebook.com/HiConInternational.com.pk>



<https://www.instagram.com/hiconinternational.com.pk/>



<https://twitter.com/HiConInt>



<https://www.linkedin.com/in/hiconinternational/>



<https://www.youtube.com/channel/UC40BB8GfxYqiGcmjU0hIPYg>